

Material	Thermally broken aluminium system
Mechanism	Sash is lifted with the comfort gear and slides the bottom rail with the help of wheels, which can carry up to 400kg sash weight
Weatherseal	The door is fully weather sealed and tested to EN standards
Glass	The door is dry glazed with EPDM and can take dual or triple sealed units up to 52mm thickness
Thermal Performance	Uw-value up to 1.3 W/m2 K, depending on the frame/vent combination
Fittings	Lift and Slide door handle coordinated with the sash weight and hardware, recessed pull handle externally with options in colour and finish. Locking cylinder is an option
Factory Finishing	Polyester powder coated available in single or dual colour

PRODUCT TYPE

SCHÜCO ASS 70.HI
LIFT & SLIDE
ALUMINIUM DOOR

TITLE

ELEVATION DRAWING

DRAWING No.

S-A-ASS70/01

DATE

2022/04/12

SCALE

CONSTRUCTION DETAILS

zylefenster

FENSTER UAB
Fermentu 4-1, LT-02244,
Vilnius, Lithuania
Phone.: + 370 5 206 0987
Mob.: +370 682 01711
Fax.: +370 5 206 0986
E-mail: info@zylefenster.com
www.zylefenster.com

SINGLE TRACK

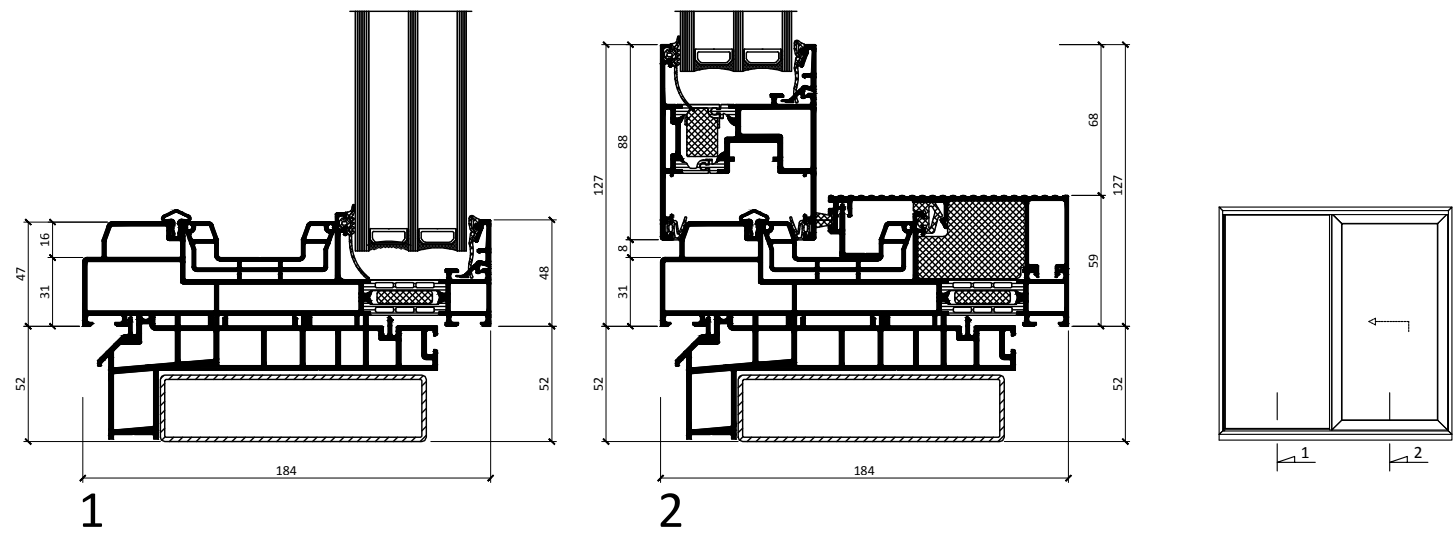

DOUBLE TRACK

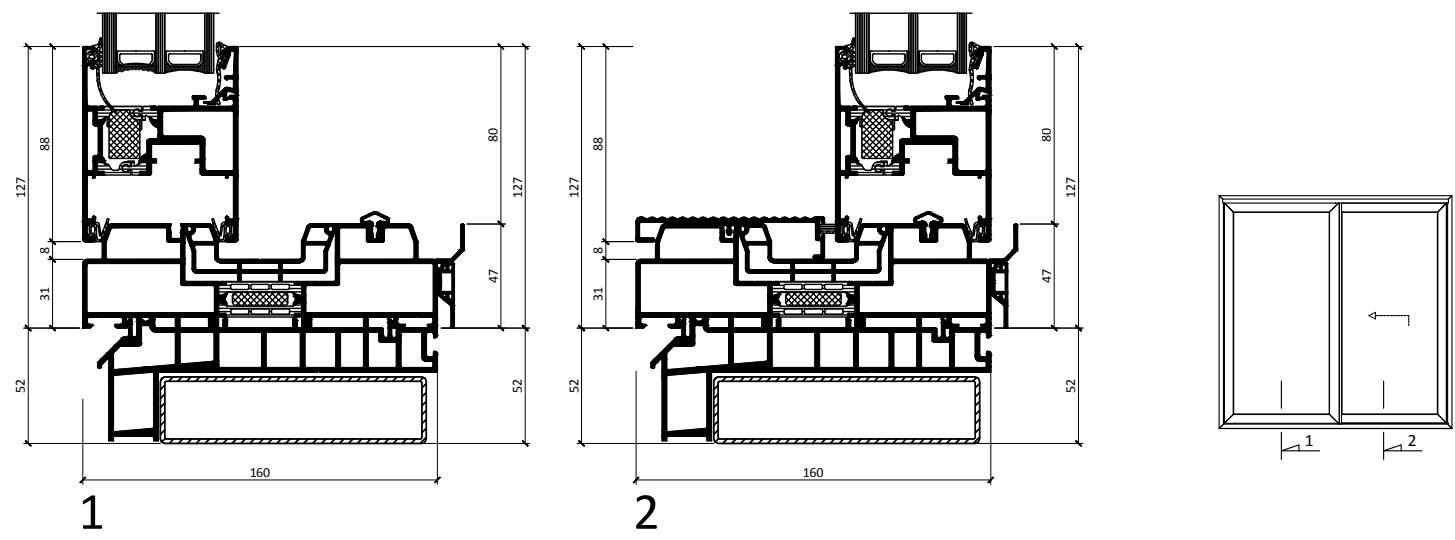

TRIPLE TRACK

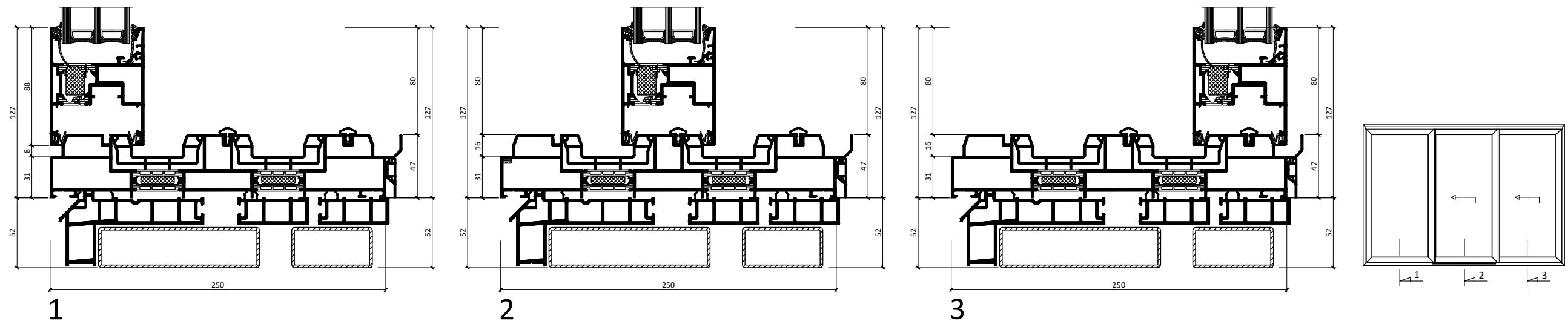

PRODUCT TYPE

SCHÜCO ASS 70.HI
LIFT & SLIDE
ALUMINIUM DOOR

TITLE

TRACK OPTIONS

DRAWING No.

S-A-ASS70/02

DATE

2022/04/12

SCALE

CONSTRUCTION DETAILS

zyle
fenster

FENSTER UAB
Fermentu 4-1, LT-02244,
Vilnius, Lithuania
Phone.: + 370 5 206 0987
Mob.: +370 682 01711
Fax.: +370 5 206 0986
E-mail: info@zylefenster.com
www.zylefenster.com